



FACTS AND INFORMATION

SHANGRI-LA KUALA LUMPUR

LOCATION

Nestled amidst lush greenery in the heart of the city, Shangri-La Kuala Lumpur is just moments from the city's leading business, shopping, entertainment districts and heritage and historical sites. The hotel is merely a five-minute walk to the iconic Petronas Twin Towers and Kuala Lumpur International Airport is only 45 minutes away by car.

ACCOMMODATION

The hotel comprises 662 luxurious guestrooms, including 69 units elegant suites, all with panoramic views of the city or the tranquil gardens. For the more discerning traveller, the Horizon Club provides the highest level of personalised attention with four floors of executive accommodation and an exclusive private lounge.

RECREATION FACILITIES

- Fully equipped health club
- Hot whirlpool baths, sauna and steam room
- Massage, reflexology and aromatherapy
- Yoga and stretching
- Outdoor swimming pool and children's pool

HORIZON CLUB PRIVILEGES

- Personalised check-in and check-out service
- Complimentary breakfast, all-day refreshments, afternoon tea and evening cocktails in Horizon Club Lounge
- Concierge service
- One Complimentary suit pressing on arrival
- Daily international newspaper
- Private meeting room and computer stations
- Complimentary Wi-Fi broadband Internet access in guestrooms and Horizon Club Lounge
- Pillow menu
- Basic secretarial services

GUESTROOM FEATURES

- Satellite / cable TV
- 24-hour in-room dining
- IDD telephones with data port and voice mail
- Full-size executive desk
- Complimentary Wi-Fi broadband Internet access
- Electronic safe
- Tea and coffee-making facilities
- Mini-bar
- Hairdryer
- Belikin BOOSTCHARGE PRO 4-Port fast Charger

OTHER SERVICES AND FACILITIES

- Limousine and taxi services
- Laundry and valet services
- Safe deposit boxes
- Parking facilities
- Hair/ beauty salon
- Shopping arcade
- Foreign exchange counter
- Tour desk
- Shuttle bus service
- Les Clefs d'Or (Golden key services)
- WeChat Communication
- AliPay payment service
- WeChat payment service
- Guest Relations for Chinese-speaking guests
- Family and Children's activities with a Chinese-speaking Kid's Ambassador



GUESTROOMS

Categories	Rooms	Area (m ²)
Deluxe Room	96	37
Executive Room	358	39
Premier Business Room	10	39
Horizon Club Executive Room	97	39
Family Executive Room	32	74
Family Premier Suite	12	80
Premier Selection Suite	52	80
Specialty Suite	3	115
Malaysian Suite	1	240
Royal Suite	1	240

PREMIER BUSINESS ROOM

The ultimate business experience mobile Plug & Play workstation and enhanced business-friendly amenities.

- Adjustable height mobile Plug & Play workstation with tabletop electrical sockets and Qi wireless charger
- 65-inch Samsung SMART TV
- Dell 27-inch 4K USB-C Hub Monitor
- Blue Yeti X Professional USB Microphone
- Creative Stage Air V2 Soundbar
- Logitech BRIO 4K Webcam
- Logitech Master MX 3S Wireless Mouse Graphite
- Logitech MX Mechanical Wireless Illuminated Keyboard
- Wi-Fi broadband Internet access

MOBILE PLUG & PLAY UPGRADE

- Adjustable Height Mobile Plug & Play Workstation
- Dell 27-inch 4K USB-C Hub Monitor (Dual Screens or Single Screen available upon request)
- PolySync 4.0 Speakerphone or Blue Yeti microphone with speaker
- Logitech BRIO 4K Webcam
- Logitech Master MX 3S Wireless Mouse Graphite
- Logitech MX Mechanical Wireless Illuminated Keyboard

RESTAURANTS AND BARS

Restaurants / Bars	Capacity	Location	Cuisine
Lafite	40 - 80	Lobby Level	For private dining facility
Lobby Lounge	136	Lobby Level	Snacks and beverages
Lemon Garden	368	Lobby Level	International buffet
Lemon Garden 2Go	61	Lobby Level	Continental with deli
Shang Palace	192	Level 1	Cantonese
Zipangu	178	Level 1	Japanese
Arthur's Bar & Grill	163	Level 1	Local and international
Poolside Terrace	46	Level 2	Snacks and beverages

BANQUET AND CONFERENCE ROOMS

Venue	Reception	Theatre	Capacity Banquet	Classroom	Boardroom	Dimensions (m)	Area (m ²)	Ceiling Height (m)
Basement II								
Grand Ballroom (Sabah + Sarawak)	1,800	1,800	1,440	660	-	34.7x43.5	1,509	6.7
Sabah	700	1,100	600	420	-	34.7x26.1	905	6.7
Sarawak	450	650	400	378	84	34.7x17.4	604	6.7
Junior Ballroom (Selangor Room + Melaka)	400	300	400	200	-	43x17.3	744	4
Selangor Room (Kedah + Selangor 1 + Perak)	360	270	340	160	-	26x17.3	449	4
Kedah	120	140	100	87	42	8.7x17.3	150	4
Selangor 1	120	140	100	87	42	8.7x17.3	150	4
Perak	120	140	100	87	42	8.7x17.3	150	4
Melaka	200	200	160	120	42	16.9x17.3	292	4
Perlis	25	30	27	18	18	8.7x5.2	45	4
Sabah Ante	-	60	40	36	18	9.6x8.3	80	3
Foyer	800	-	-	-	-	-	1,151	4
Lower Lobby								
Johor 1/2/3	45	60	40	33	18	8.7x7.1	61	3.7
Johor (Johor 1+2+3)	140	160	120	100	60	26x7.1	184	3.7
Grand Johor (Johor 1+2+3+4+5+6)	360	270	340	160	-	26x15.8	410	3.7
Johor 1+4 / 2+5 / 3+6	120	140	100	87	42	8.7x15.8	137	3.7
Kelantan	70	80	50	45	36	6.2x14.1	87	3.7
Penang	80	90	50	48	36	6.2x16.1	100	3.7
Foyer	400	-	-	-	-	-	620	3.7
Level 1								
Mezzanine 1,2&3	-	-	-	-	14	8.8x3.6	32	3.0
Mezzanine 4	-	-	-	-	8	3.5x5.7	20	3.0

LOWER LOBBY

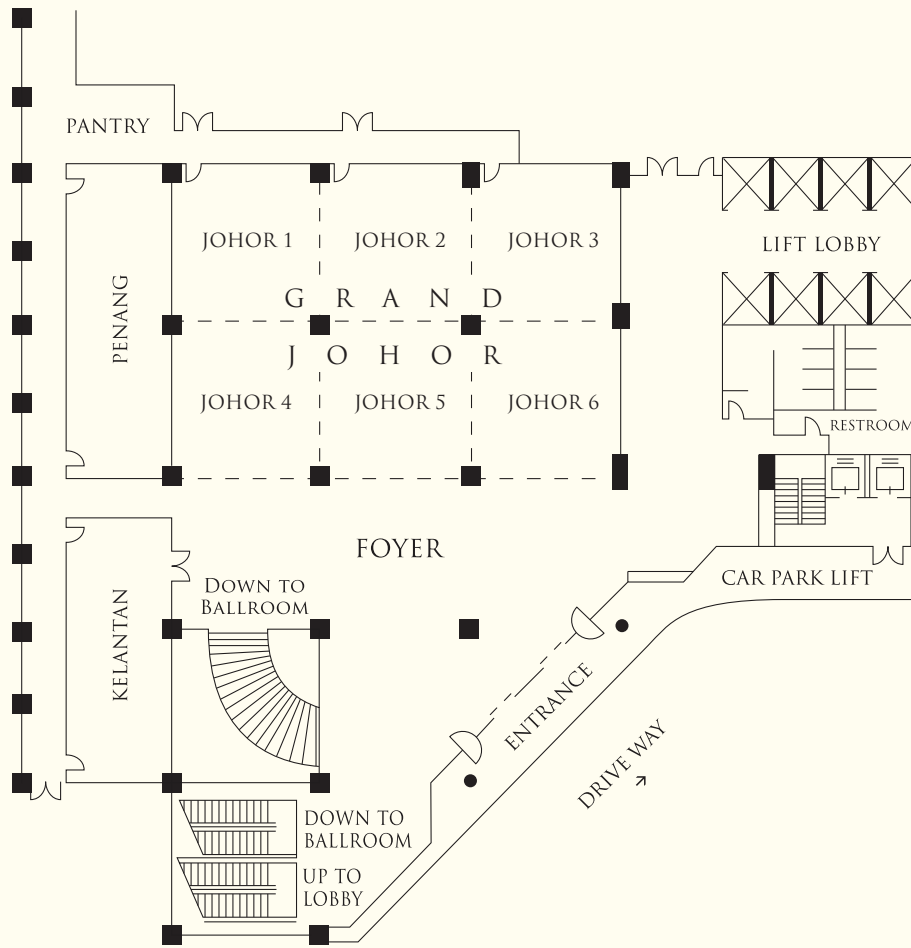

LEVEL I

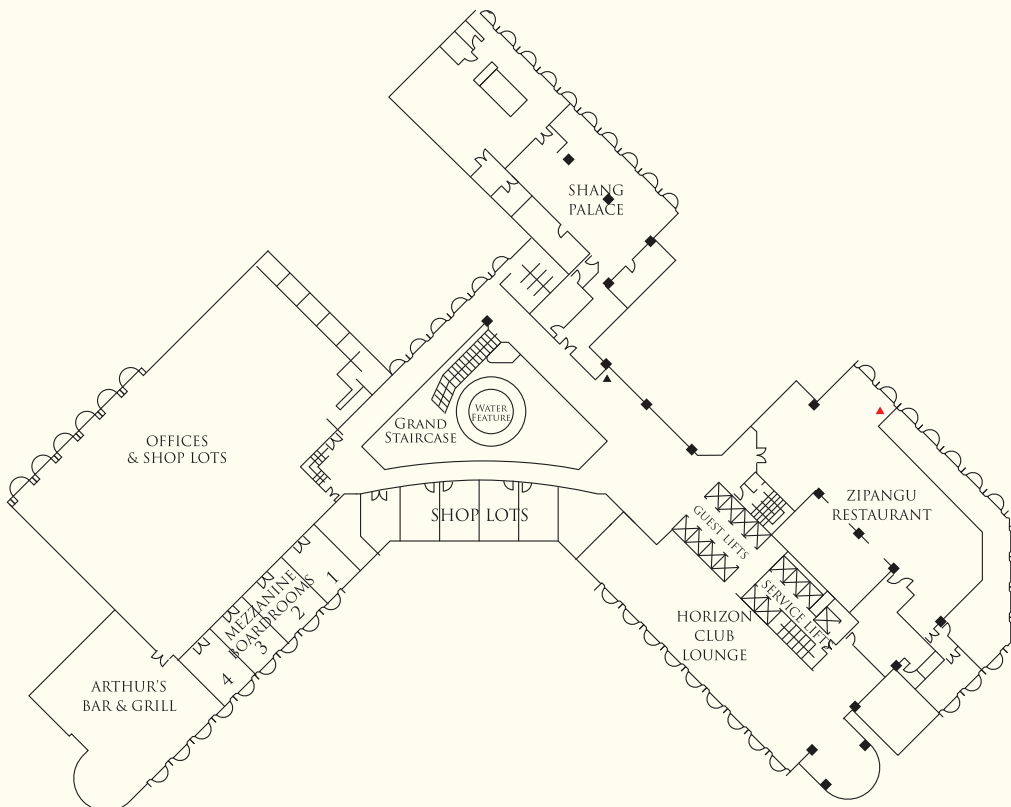

BASEMENT II

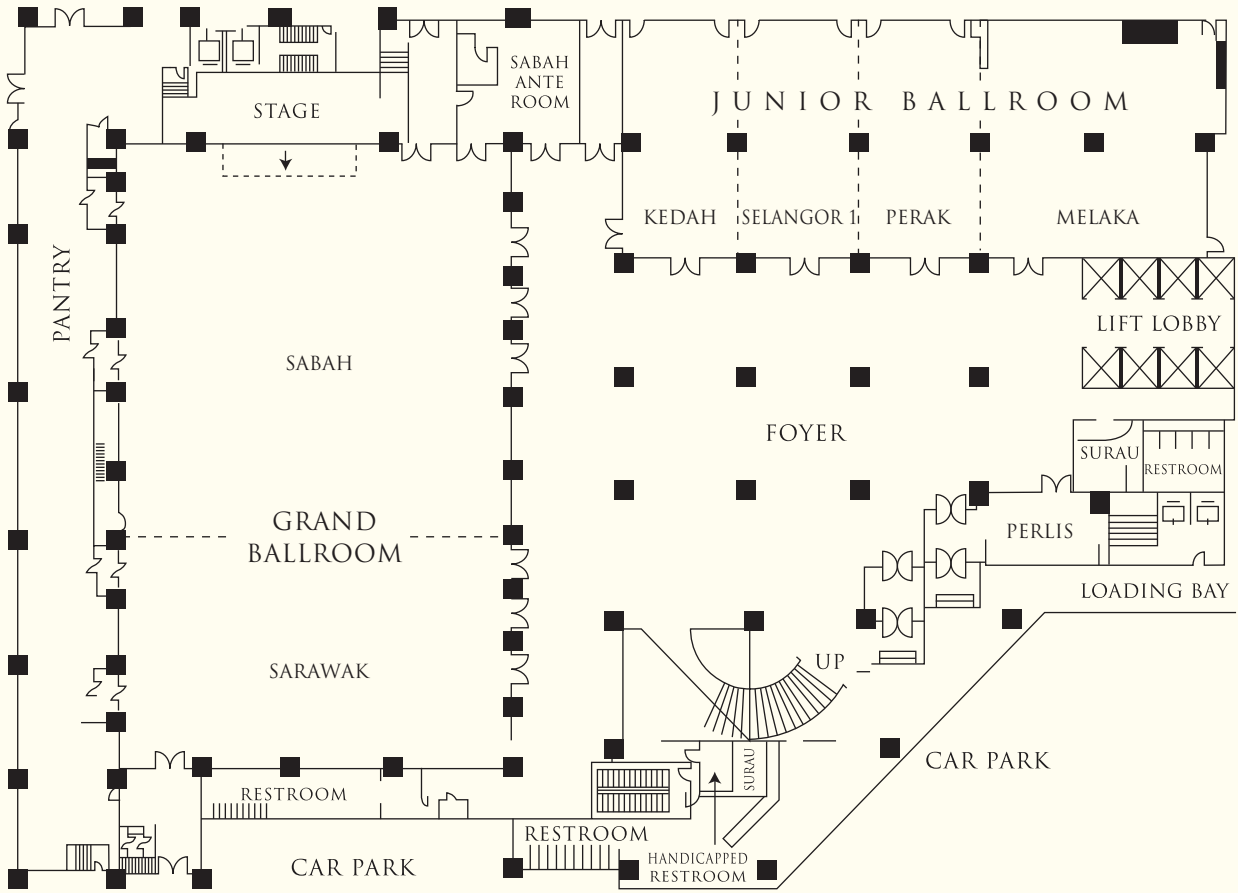

LOBBY

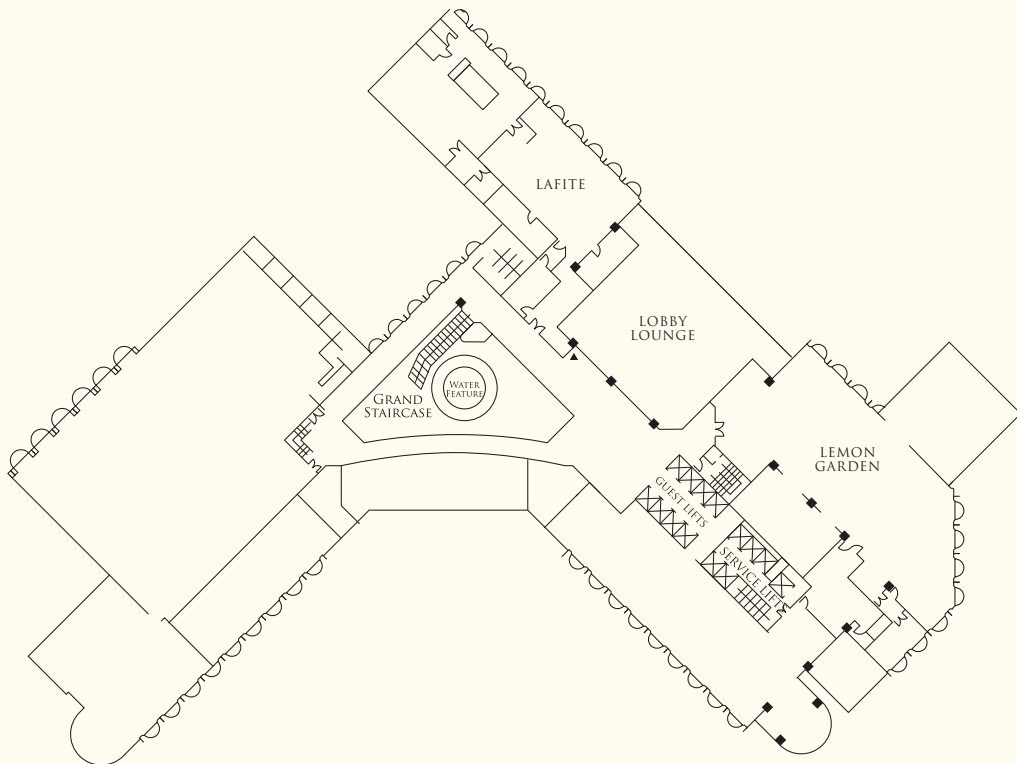



SHANGRI-LA

SHANGRI-LA HOTEL (KL) SENDIRIAN BERHAD
Registration No. 196901000758 (9159-V)

11, Jalan Sultan Ismail, 50250 Kuala Lumpur, Malaysia

Tel: (603) 2032 2388 Fax: (603) 2070 1514 kualalumpur@shangri-la.com www.shangri-la.com